

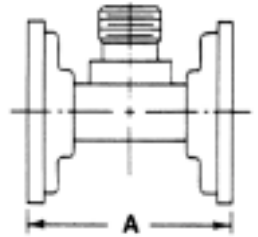

# RECTANGULAR WAVEGUIDE POWER SAMPLERS 50 SERIES

DATA  
SHEET  
No. T47D

- FLAT COUPLING
- FULL WAVEGUIDE BAND
- LOWEST VSWR, 1.02 TYPICAL



## DESCRIPTION

MEC Power Samplers provide an economical non-directional means of monitoring the power in a matched waveguide system. The units are available with coupling values of 30 to 60 dB and frequency sensitivity of  $\pm 1.0$  dB maximum ( $\pm 0.5$  dB typical) over the full bandwidth. Main line VSWR is 1.04 maximum. The sampling port is normally supplied with type N, SMA, or 7mm output connectors. Other types and coupling levels are available upon request. Cover flanges are provided on the main line unless otherwise specified. Assemblies have aluminum housings with chromate conversion per MIL-C-5541, Class 3, painted with gray epoxy enamel on external non-mating surfaces.

## SPECIFICATIONS

MODEL NO.	FREQUENCY RANGE (GHz)	WAVEGUIDE SIZE	DIM. A (INCHES)
E50	1.0-1.45	WR-770	3.00
L50	1.12-1.70	WR0-650	3.00
LM50	1.45-2.20	WR-510	3.00
LA50	1.70-2.60	WR-430	3.00
LS50	2.20-3.30	WR-340	3.00
S50	2.60-3.95	WR-284	3.00
B50	3.3-4.9	WR-229	2.00
G50	3.95-5.85	WR-187	3.00
D50	4.90-7.05	WR-159	2.50
J50	5.85-8.20	WR-137	2.00

MODEL NO.	FREQUENCY RANGE (GHz)	WAVEGUIDE SIZE	DIM. A (INCHES)
H50	7.05-10.0	WR-112	2.00
W50	7.0-11.0	WR-102	2.00
X50	8.2-12.4	WR-90	2.00
M50	10.0-15.0	WR-75	2.00
P50	12.4-18.0	WR-62	2.00 $\Delta$
N50	15.0-22.0	WR-51	1.00
K50**	18.00-26.50	WR-42	1.00
Y50*	22.0-33.0	WR-34	1.00
A50*	26.5-40.0	WR-28	1.00

\* Available Only with SSMA Connector, K-Connector or 2.4mm  
 \*\* Available With SMA up to 26.0 GHz. SSMA, K-Conn., or 2.4>26GHz  
 $\Delta$  P50(-)3 length is 1.00"

## ORDERING INFORMATION

- Add the following suffixes to model number to specify coupling and connector:
  - COUPLING: -30 for 30 dB -40 for 40 dB -50 for 50 dB -60 for 60dB
  - CONNECTOR: "N" for type N female "3" for SMA female "7" for precision 7mm\*
 EXAMPLE: X50-43 is a WR-90 Waveguide 40dB sampler shown with SMA Female Connector.
- Units above 7 GHz are also available in the flange sampler shown at right with tapped holes. Specify 50S. Length (A) is 0.75" for type N and 0.55" for SMA.  
 EXAMPLE: X50S-40-3

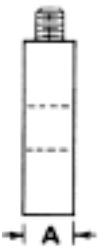

\*Refer to Data Sheet T100 for a complete list of available connectors

Data subject to change without notice



MICROWAVE ENGINEERING CORPORATION  
 1551 OSGOOD STREET, NORTH ANDOVER, MA 01845 • TEL (978) 685-2776 • FAX (978) 975-4363  
 Website: [www.microwaveeng.com](http://www.microwaveeng.com), Email: [sales@microwaveeng.com](mailto:sales@microwaveeng.com)