



QUAD-RIDGE WAVEGUIDE TERMINATIONS Q80 SERIES

**DATA
SHEET
No.T404**

- **LOW VSWR**
- **FULL BANDWIDTH**
- **POWER & COOLING OPTIONS**

DESCRIPTION

MEC Quad-Ridge Waveguide Terminations cover the full frequency band with low VSWR:

1. (L) Low power having lowest VSWR for precise laboratory measurements.
2. (LS) Same as (L) except with a movable plunger and locking mechanism for higher precision and calibration of standards.
3. (W) Water or Liquid Load where the coolant is the RF absorber for high power testing and calorimetric measurements. They operate at typical fluid pressure of 10 PSIG and a flow rate of 0.5 Gallon per minute for every 1 kW of average RF power.

Standard flanges are cover, MEC-C3 Series. Other flanges are optional. Finish is chromate conversion per MIL-C-5541, Class 3. Paint is epoxy enamel; color is gray for the (L) & (LS) series and black for all W-Series.

A power sampler can be incorporated in any of the terminations for one or both linear modes. Sampling levels range from 30 to 50 dB with typical flatness of ± 1 dB. For power sampling option add “-PS” to the model number followed by coupling value.

For terminations with custom frequency bands, size, heat sink, cooling fan or other options, please contact us.

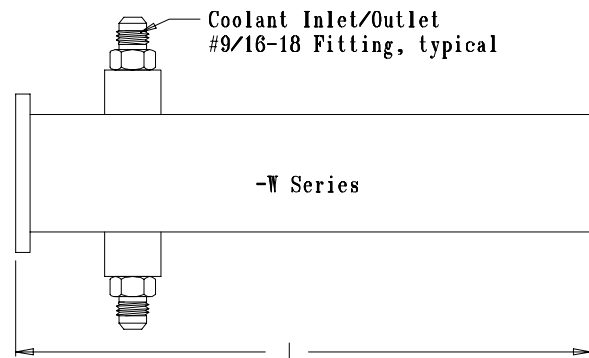
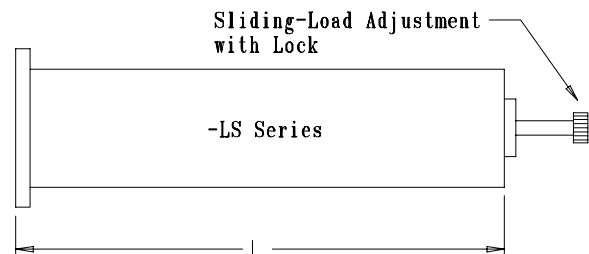
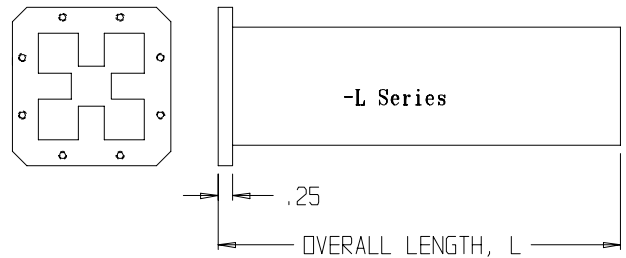

MODEL NUMBER	FREQUENCY RANGE (GHz)	WAVEGUIDE SIZE	MAX. AV. POWER (WATTS)	VSWR (MAX.)	LENGTH L (MAX. IN.)
Q87-L	7.5-18.0	Q650-D28	5	1.04:1	6"
Q87-LS			5	1.04:1	8"
Q87-W			2,000	1.2:1	14"
Q82-L	2.5-7.5	Q250-D30	10	1.04	10"
Q82-LS			10	1.04	12"
Q82-W			2,000	1.2:1	20"

Data subject to change without notice



MICROWAVE ENGINEERING CORPORATION

1551 OSGOOD STREET, NORTH ANDOVER, MA 01845 • TEL (978) 685-2776 • FAX (978) 975-4363

Website: www.microwaveeng.com, Email: sales@microwaveeng.com