

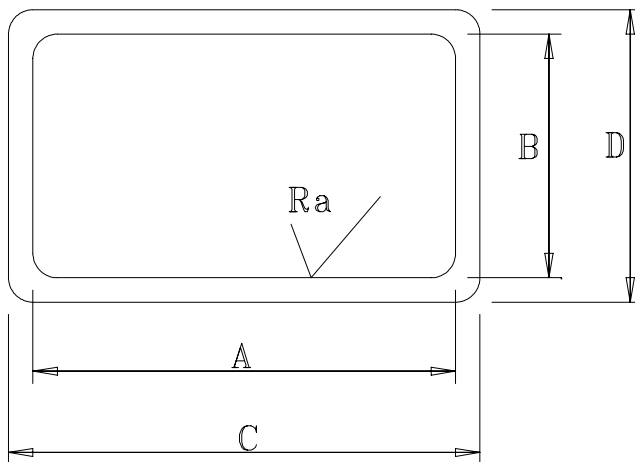

STANDARD RECTANGULAR WAVEGUIDE

DATA SHEET
No. T110

Waveguide Size Europe And USA			Internal Dimensions A x B				External Dimensions C x D				Wall Thickness		Internal Surface Finish (Ra)	
R	Wg	Wr	mm	tol.±	inches	tol.±	mm	tol.±	Inches	tol.±	mm	Inch	μ meter	μ inches
14	6	650	165.10x82.55	0.25	6.500x3.250	.01	170.30x87.75	0.25	6.704x3.455	0.01	2.6	0.1	40	1.6
22	8	430	109.22x54.61	0.14	4.300x2.150	.006	113.28x58.67	0.15	4.460x2.310	0.006	2.03	0.08	40	1.6
26	9A	340	86.36x43.18	0.11	3.400x1.700	.005	90.42x47.24	0.13	3.560x1.860	0.005	2.03	0.08	40	1.6
32	10	284	72.14x34.04	0.08	2.840x1.340	.004	76.20x38.10	0.1	3.000x1.500	0.004	2.03	0.08	25	1
40	11A	229	58.17x29.083	0.06	2.290x1.145	.003	61.42x32.33	0.08	2.418x1.273	0.003	1.625	0.064	25	1
48	12	187	47.55x22.149	0.05	1.872x0.872	.003	50.80x25.40	0.08	2.000x1.000	0.002	1.625	0.064	25	1
58	13	159	40.39x20.139	0.05	1.590x0.795	.002	43.64x23.44	0.05	1.718x0.923	0.002	1.625	0.064	25	1
70	14	137	34.85x15.799	0.04	1.372x0.622	.002	38.10x19.05	0.05	1.500x0.750	0.002	1.625	0.064	25	1
84	15	112	28.499x12.624	0.03	1.122x0.497	.002	31.75x15.88	0.05	1.250x0.625	0.001	1.625	0.064	25	1
100	16	90	22.86 x10.16	0.03	0.900x0.400	.001	25.40x12.70	0.03	1.000x0.500	0.001	1.27	0.05	25	1
120	17	75	19.05x9.525	0.02	0.750x0.375	.001	21.59x12.06	0.03	0.850x0.475	0.001	1.27	0.05	25	1
140	18	62	15.799x7.899	0.02	0.622x0.311	.0008	17.83x9.930	0.03	0.702x0.391	0.001	1.016	0.04	25	1
180	19	51	12.954x6.477	0.02	0.510x0.255	.0008	14.99x8.510	0.03	0.590x0.335	0.001	1.016	0.04	25	1
220	20	42	10.668x4.318	0.02	0.420x0.170	.0008	12.70x6.350	0.03	0.500x0.250	0.001	1.016	0.04	25	1
280	21	34	8.636x4.318	0.02	0.340x0.170	.0008	10.57x6.350	0.03	0.420x0.250	0.001	1.016	0.04	25	1
320	22	28	7.112x3.556	0.02	0.280x0.140	.0008	9.14x5.590	0.03	0.360x0.220	0.001	1.016	0.04	25	1
400	23	22	5.690x2.845	0.02	0.224x0.112	.0008	7.72x4.880	0.03	0.304x0.192	0.001	1.016	0.04	25	1
500	24	19	4.775x2.388	0.02	0.188x0.094	.0008	5.81x4.420	0.03	0.268x0.174	0.001	1.016	0.04	25	1
620	25	15	3.759x1.880	0.02	0.148x0.074	.0008	5.79x3.910	0.03	0.228x0.154	0.001	1.016	0.04	25	1
740	26	12	3.099x1.549	0.02	0.122x0.61	.0008	5.13x3.580	0.03	0.202x0.141	0.001	1.016	0.04	25	1
900	27	10	2.540x1.270	0.02	0.100x0.050	.0008	4.57x3.300	0.03	0.160x0.130	0.001	1.016	0.04	25	1



Length: 3050 mm (Other upon request)
Alloy: 6063 (Other upon request)

Straightness and twist:
DIN 17615

Availability from stock ensures a swift delivery worldwide

Data subject to change without notice



MICROWAVE ENGINEERING CORPORATION
1551 OSGOOD STREET, NORTH ANDOVER, MA 01845 • TEL (978) 685-2776 • FAX (978) 975-4363

Website: www.microwaveeng.com, Email: sales@microwaveeng.com